

INSTRUCCIONES DE MONTAJE / INSTALLATION INSTRUCTIONS

HOLP DOWNLIGHT
 01845-xS9xx 01846-xS9xx
 01855-xS9xx 01856-xS9xx
 01875-xS9xx 01876-xS9xx

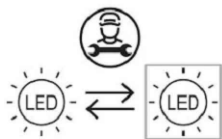

Fuente de luz reemplazable (sólo LED) por un profesional.
 Replaceable (LED only) light source by a professional.



Equipo de control reemplazable por un profesional.
 Replaceable control gear by a professional.

Nexia
 Culture x light

NEXIA ILUMINACIÓN S.L.
 Polígono Industrial Can Carnar
 C/ Priorat, 14-20, 08211 Castellar del Vallès
 Barcelona, SPAIN
 Tel. +34 93 715 47 12
 info@nexia.es www.nexia.es

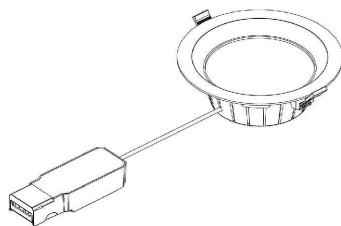

Dimensiones / Dimensions:

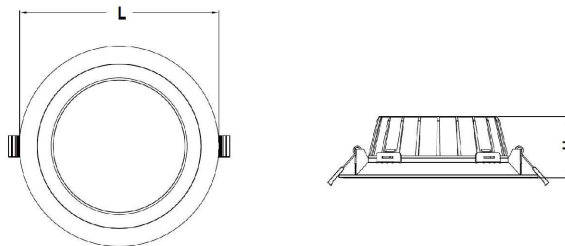

01845-xS90R L=Ø110mm H=52mm
 01855-xS91R L=Ø146mm H=52mm
 01875-xS93x L=Ø226mm H=54mm

01846-xS90R L=Ø110mm H= 72 mm
 01856-xS91R L=Ø146mm H= 72 mm
 01876-xS93x L=Ø226mm H= 87 mm

FIG-1

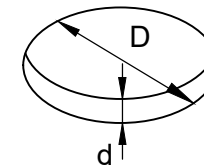
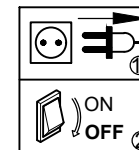

	Empotramiento Cut-out (D)	Espesor Thickness (d)
01845-	Ø 90 mm	3-20 mm
01855-	Ø 120 mm	3-20 mm
01875-	Ø 200 mm	3-20 mm
01846-	Ø 90 mm	3-24 mm
01856-	Ø 120 mm	3-24 mm
01876-	Ø 200 mm	3-24 mm

FIG-2

Atención:
 Al cambiar la temp. de color, asegúrese de que la alimentación esté apagada.
Attention:
 When switching the color temperature, sure the power is off.

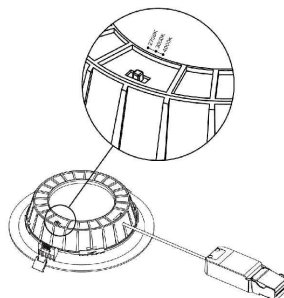

AZUL / BLUE N
 MARRÓN, NEGRO / BROWN, BLACK L1

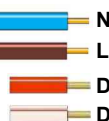

FIG-3

Línea pulsador / Push button line D1 *Only for Ref. xxxx-xxxxD
 Neutro pulsador / Neutral push button D2

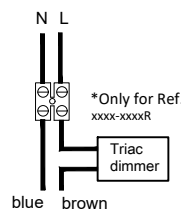
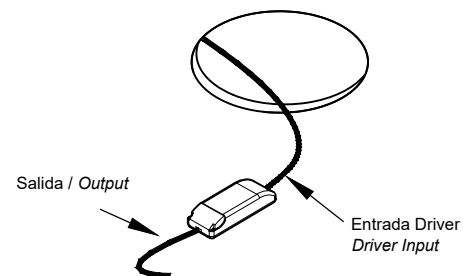

FIG-4

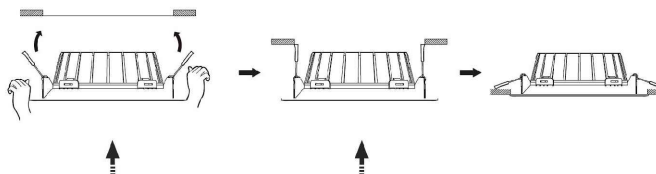
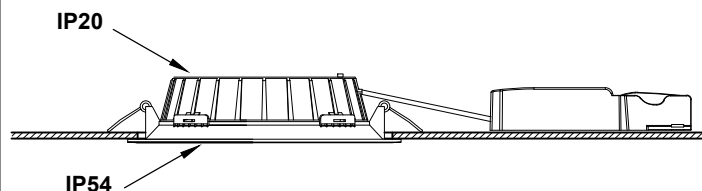

FIG-5



No cubrir las luminarias con material aislante térmico.
 Don't cover luminaires with thermal insulation material.

Uso exclusivo para interiores.
 For indoor use only.



FIG-6

