

INSTRUCCIONES DE MONTAJE / INSTALLATION INSTRUCTIONS

HUT

01810-XXXX / 01820-XXXX / 01830-XXXX



ES: La fuente de luz de esta luminaria es no reemplazable; cuando la fuente de luz alcance el final de su vida, se debe sustituir la luminaria completa.

EN: The light source of this luminaire is non-replaceable; When the light source reaches the end of its life, the complete luminaire must be replaced.

ES: Se debe mantener un aislamiento reforzado entre la alimentación en baja tensión (BT) y los conductores de control.

EN: A reinforced insulation must be maintained between the low voltage supply (LV) and the control conductors.

Nexia
Culture x light

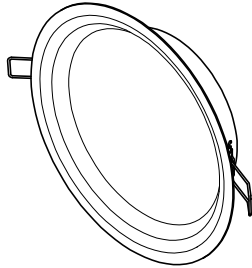

NEXIA ILUMINACIÓN S.L.
Polígono Industrial Can Carner
C/ Priorat, 14-20, 08211 Castellar del Vallès
Barcelona, SPAIN
Tel. +34 93 715 47 12
info@nexia.es www.nexia.es

FIG-1

	D	d
Ref: 01810-xxxxx	Ø80mm	MAX: 15mm
Ref: 01820-xxxxx	Ø180/200mm	MAX: 15mm
Ref: 01830-xxxxx	Ø115mm	MAX: 15mm

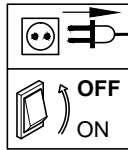
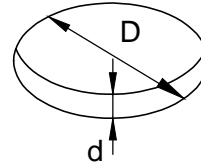
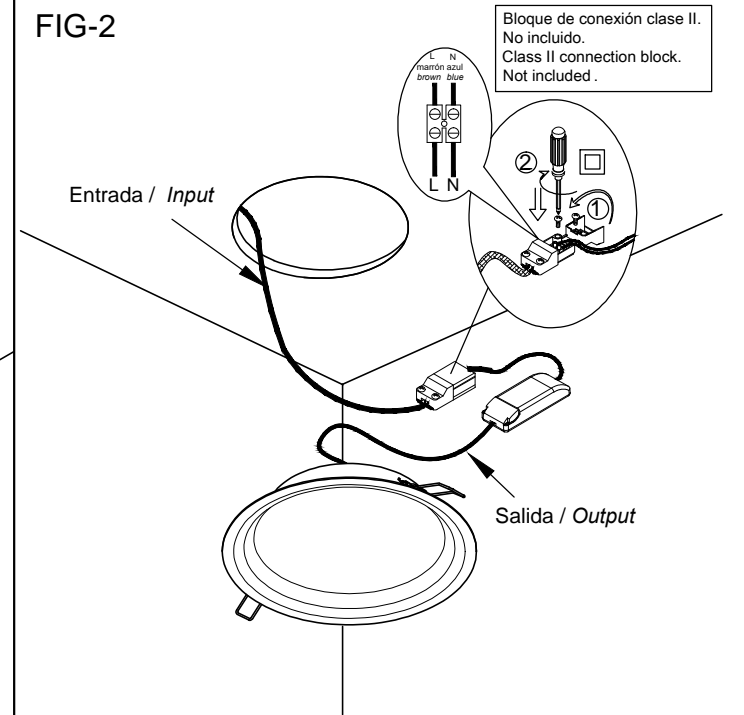
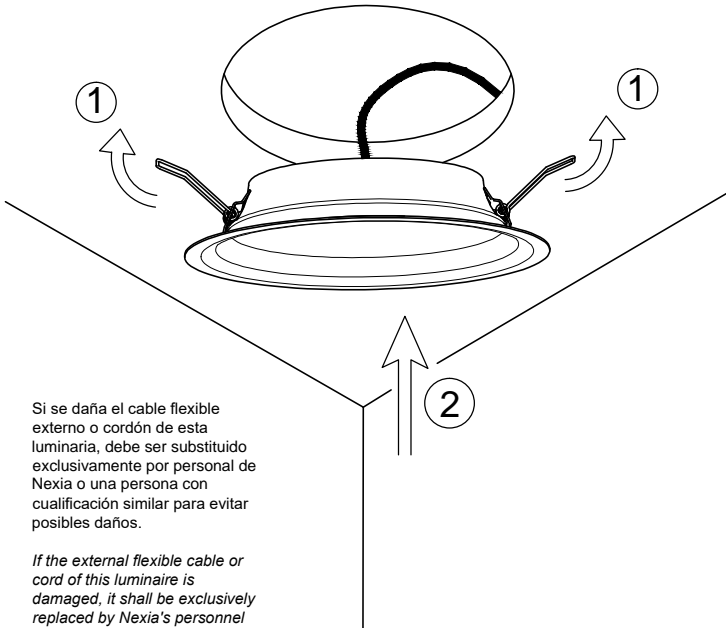

FIG-2



Bloque de conexión clase II.
No incluido.
Class II connection block.
Not included.

FIG-3



Si se daña el cable flexible externo o cordón de esta luminaria, debe ser substituido exclusivamente por personal de Nexia o una persona con cualificación similar para evitar posibles daños.

If the external flexible cable or cord of this luminaire is damaged, it shall be exclusively replaced by Nexia's personnel or a similar qualified person in order to avoid a hazard.

FIG-4

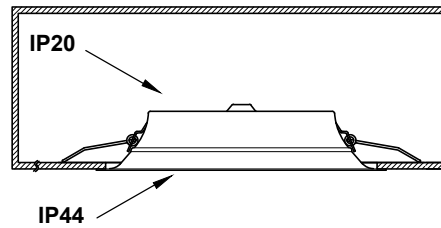

No cubrir las luminarias con material aislante térmico.
Don't cover luminaires with thermal insulation material.

Uso exclusivo para interiores.
For indoor use only.

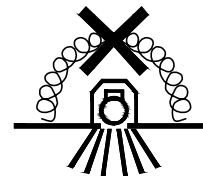

FIG-5

